

TILLAMOOK COUNTY SURVEYORS OFFICE

Center 1/4 corner of Section 27 T.1N.,R.10W..W.M.

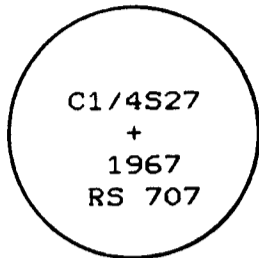

I set a 10" concrete cylinder around a found O.S.B.F. 1 1/2" iron pipe with 3" bronze cap, approximately 18" deep, set in 1967. (See Tillamook County Surveyors map #B-540

-----  
History of Found Monument

This corner was originally set by Harold J. Russell L.S. 707 for Oregon State Board of Forestry on Tillamook County Surveyors map #B-540. The condition of the accessories set at that time are now as follows:

47" hemlock N.20 1/4\*W. 18.1'; (Found, now a 51" burnt stump, the face is partially healed and exposed part is burnt, 17.8'. Also found rusty remains of O.S.B.F. yellow metal location poster attached).

14" hemlock S.58 1/2\*W. 30.6'; (Found now 22" burnt stump, the face is partially healed and exposed part is burnt, 30.4').

W.C.P.C. 1.0' NW; (Now gone).

-----  
New Accessories

\*72" light hat section post North 1.5'.

No new bearing trees available.

\*indicates yellow Tillamook County location poster attached.

-----  
Monument location

This monument is located approximately 100' North of a spur ridge, approximately 75' South of a small creek, and approximately 250' NEly of a spur logging road in a recent clear cut, slash burn area.

-----  
In the presence of Dan McNutt & Al Dvorak

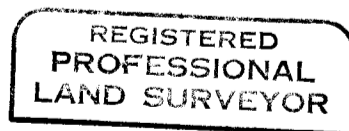
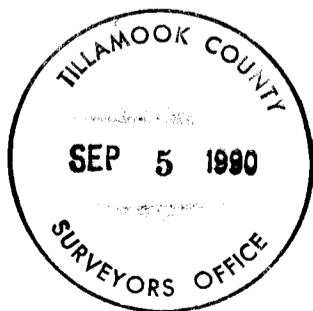

*Allan E. Duncan, C.S.*

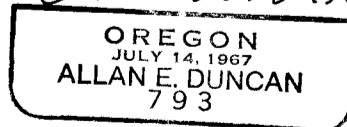

August 1990

Title: